

LandCruiser 200

Corrections to Repair Manual RM22W1E

Please ensure these pages are distributed to all relevant staff for their information; and a copy made available for future reference, with the above repair manual.

Section	Title	Paragraph
SUPPLEMENTAL RESTRAINT SYSTEM	SPIRAL CABLE	INSTALLATION (201301-201308)
		INSTALLATION (201308-)

The revised pages listed above are attached.
(The corrected parts are indicated by arrows.)

This Bulletin does not cause the Flat Rate Manual to be changed.

Tester Connection	Condition	Specified Condition
E12-10 - z36-3	Always	Below 1 Ω
E12-9 - z36-2	Always	Below 1 Ω
E12-8 - z36-1	Always	Below 1 Ω
E12-8 - z37-2	Always	Below 1 Ω
E12-7 - z37-1	Always	Below 1 Ω

NOTICE:

As the spiral cable may break, do not rotate the spiral cable more than the specified amount.

INSTALLATION [(2013/01-2013/08)]

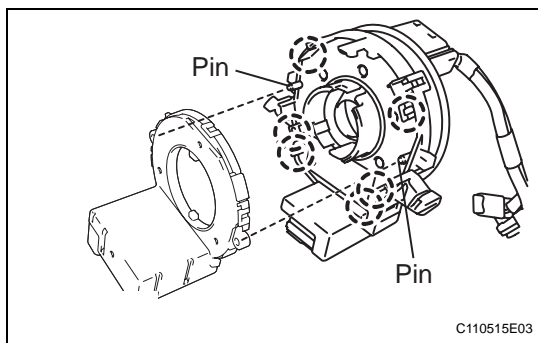

1. INSTALL SPIRAL CABLE

- Align the pins on the spiral cable with the installation holes on the steering sensor.
- Attach the 6 claws and install the spiral cable to the steering sensor.
- Check that the front wheels are facing straight ahead.
- Set the turn signal switch to the neutral position.

CAUTION:

If it is not in the neutral position, the pin of the turn signal switch may be snapped.

- Attach the 3 claws to install the spiral cable with steering sensor.

CAUTION:

When replacing the spiral cable with a new one, remove the lock pin before installing the steering wheel assembly.

- Connect the connectors to the spiral cable with steering sensor.

NOTICE:

When handling the airbag connector, take care not to damage the airbag wire harness.

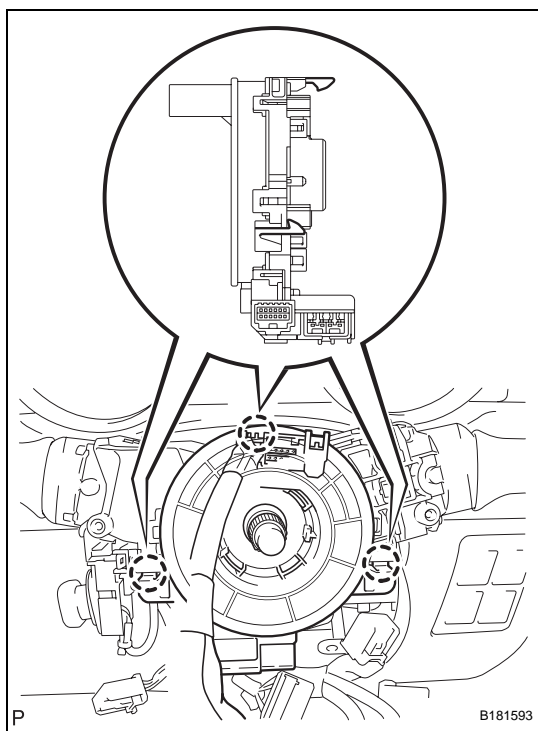

2. INSTALL UPPER STEERING COLUMN COVER (See page)

3. INSTALL LOWER STEERING COLUMN COVER (See page)

4. ADJUST SPIRAL CABLE

- Check that the ignition switch is off.
- Check that the cable is disconnected from the battery negative (-) terminal.

CAUTION:

Wait at least 90 seconds after disconnecting the cable from the negative (-) battery terminal to disable the SRS system.

- Check the check window shown in the illustration.

HINT:

When the spiral cable is centered, the connector is at the top and the conditions below can be checked.





[Corrected]

SUPPLEMENTAL RESTRAINT SYSTEMS – SPIRAL CABLE

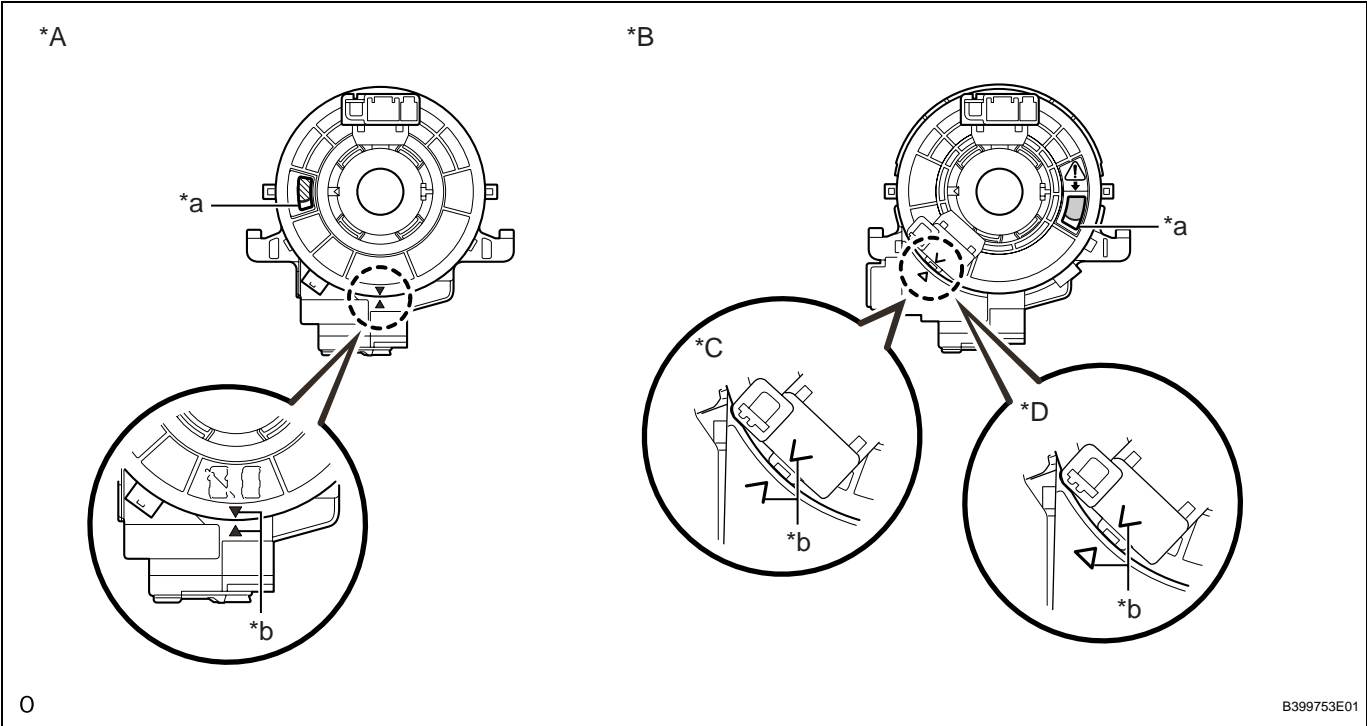
- w/o Steering Heater:
With the steering wheel straight ahead, align the matchmarks to check the colored roller from the check window.
- w/ Steering Heater:
With the steering wheel straight ahead, align the matchmarks to check the U-turn point of the cable from the check window.



Text in Illustration

*A	w/o Steering Heater	*B	w/ Steering Heater
*C	for Type A	*D	for Type B
*a	Check Window	*b	Matchmark
	Colored Roller		U-turn Point

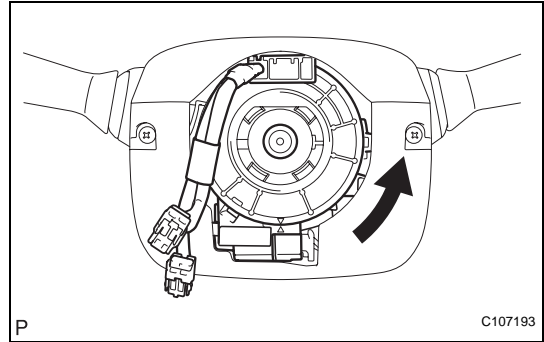



- (d) If the spiral cable is not centered, center it.
- (e) Rotate the spiral cable counterclockwise slowly by hand until it stops.
CAUTION:
Do not turn the spiral cable using the airbag wire harness.
- (f) Rotate the spiral cable 2.5 times clockwise from the lock position to align the matchmarks and check the check window.
HINT:
 - The spiral cable will rotate approximately 2.5 turns to both the left and right from the center.
 - When the spiral cable is centered, the connector is at the top and the conditions below can be checked.

SUPPLEMENTAL RESTRAINT SYSTEMS – SPIRAL CABLE

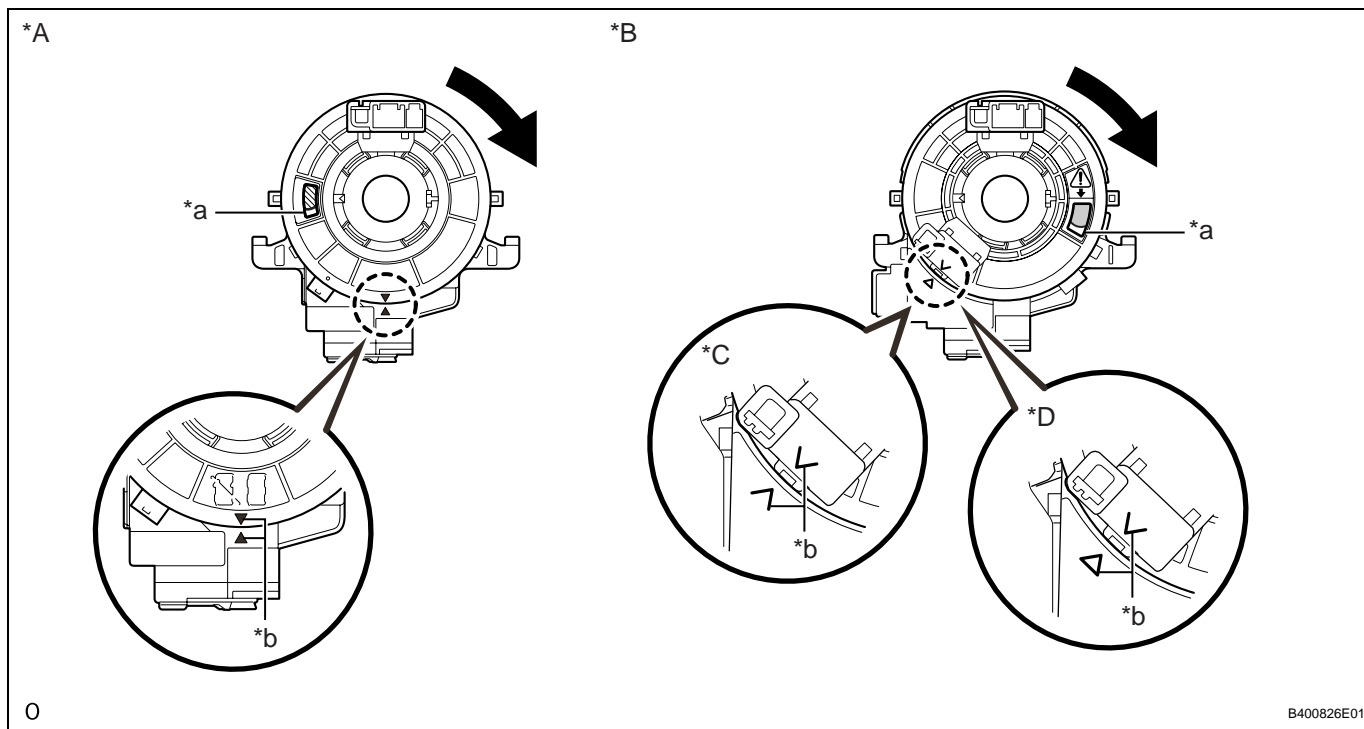
- w/o Steering Heater:
With the steering wheel straight ahead, align the matchmarks to check the colored roller from the check window.
- w/ Steering Heater:
With the steering wheel straight ahead, align the matchmarks to check the U-turn point of the cable from the check window.



Text in Illustration

*A	w/o Steering Heater	*B	w/ Steering Heater
*C	for Type A	*D	for Type B
*a	Check Window	*b	Matchmark
	Colored Roller		U-turn Point

If the spiral cable cannot be centered, it is possible that the spiral cable is broken. Replace the spiral cable with a new one.

5. INSTALL STEERING WHEEL ASSEMBLY (See page)
6. INSTALL STEERING PAD (See page)
7. INSTALL LOWER NO. 3 STEERING WHEEL COVER (See page)
8. INSTALL LOWER NO. 2 STEERING WHEEL COVER (See page)

SUPPLEMENTAL RESTRAINT SYSTEMS – SPIRAL CABLE

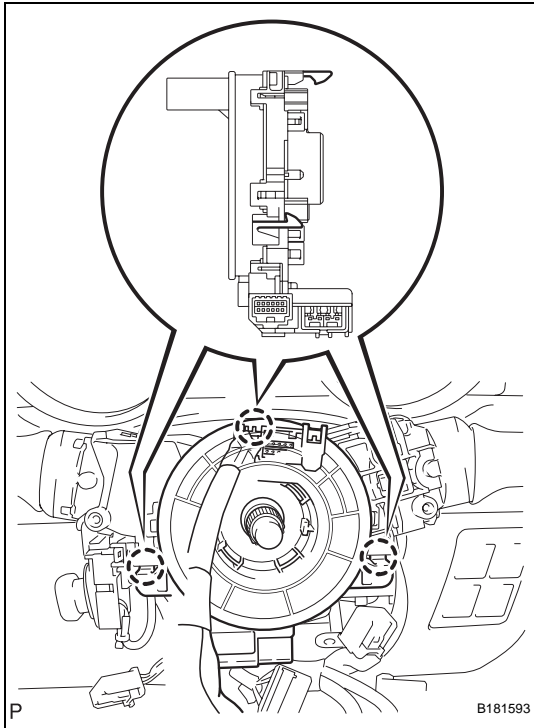

- (e) Attach the 3 claws to install the spiral cable with steering sensor.

CAUTION:

When replacing the spiral cable with a new one, remove the lock pin before installing the steering wheel assembly.

- (f) Connect the connectors to the spiral cable with steering sensor.

NOTICE:

When handling the airbag connector, take care not to damage the airbag wire harness.

2. **INSTALL UPPER STEERING COLUMN COVER (See page)**
3. **INSTALL LOWER STEERING COLUMN COVER (See page)**
4. **ADJUST SPIRAL CABLE**

- (a) Check that the ignition switch is off.
- (b) Check that the cable is disconnected from the battery negative (-) terminal.

CAUTION:

Wait at least 90 seconds after disconnecting the cable from the negative (-) battery terminal to disable the SRS system.

- (c) Check the check window shown in the illustration.

HINT:

When the spiral cable is centered, the connector is at the top and the conditions below can be checked.



- w/o Steering Heater:
With the steering wheel straight ahead, align the matchmarks to check the colored roller from the check window.
- w/ Steering Heater:
With the steering wheel straight ahead, align the matchmarks to check the U-turn point of the cable from the check window.

[Corrected]

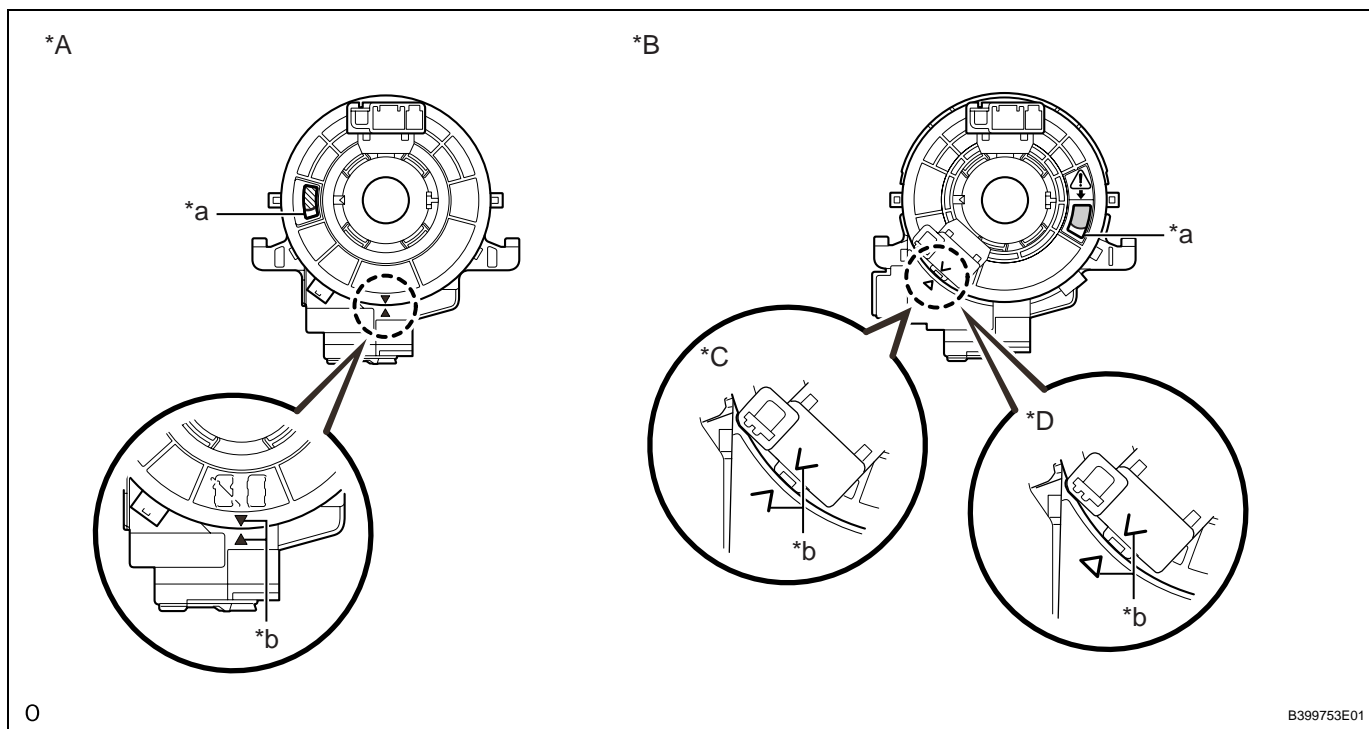
SUPPLEMENTAL RESTRAINT SYSTEMS – SPIRAL CABLE



Text in Illustration

*A	w/o Steering Heater	*B	w/ Steering Heater
*C	for Type A	*D	for Type B
*a	Check Window	*b	Matchmark
	Colored Roller		U-turn Point

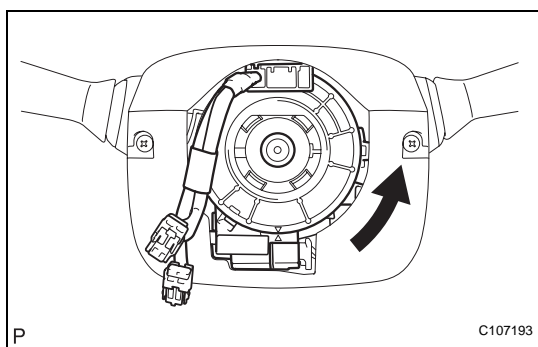

- (d) If the spiral cable is not centered, center it.
- (e) Rotate the spiral cable counterclockwise slowly by hand until it stops.
- CAUTION:**
Do not turn the spiral cable using the airbag wire harness.
- (f) Rotate the spiral cable 2.5 times clockwise from the lock position to align the matchmarks and check the check window.
- HINT:**
- The spiral cable will rotate approximately 2.5 turns to both the left and right from the center.
 - When the spiral cable is centered, the connector is at the top and the conditions below can be checked.
 - w/o Steering Heater:
With the steering wheel straight ahead, align the matchmarks to check the colored roller from the check window.
 - w/ Steering Heater:
With the steering wheel straight ahead, align the matchmarks to check the U-turn point of the cable from the check window.



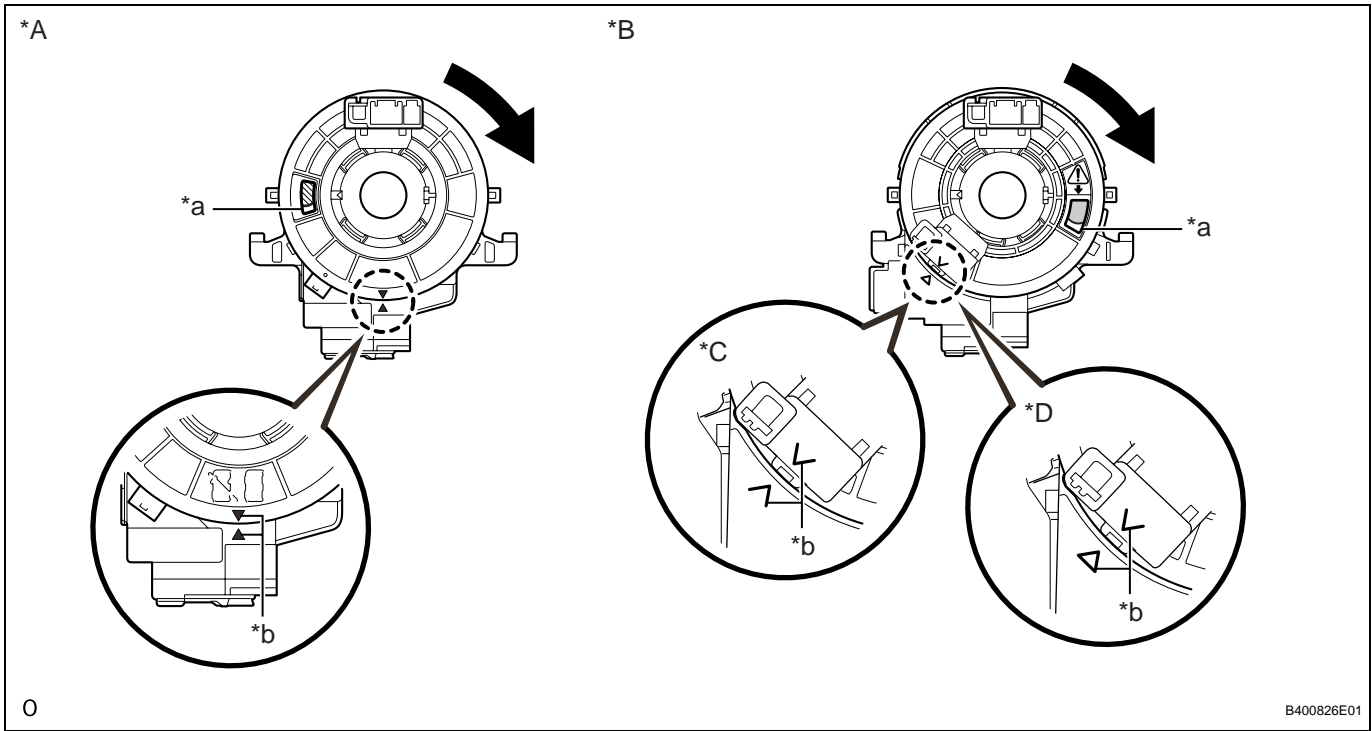

SUPPLEMENTAL RESTRAINT SYSTEMS – SPIRAL CABLE

RS



Text in Illustration

*A	w/o Steering Heater	*B	w/ Steering Heater
*C	for Type A	*D	for Type B
*a	Check Window	*b	Matchmark
	Colored Roller		U-turn Point

If the spiral cable cannot be centered, it is possible that the spiral cable is broken. Replace the spiral cable with a new one.

5. **INSTALL STEERING WHEEL ASSEMBLY** (See page)
6. **INSTALL STEERING PAD** (See page)
7. **INSTALL LOWER NO. 3 STEERING WHEEL COVER** (See page)
8. **INSTALL LOWER NO. 2 STEERING WHEEL COVER** (See page)
9. **CONNECT CABLE TO NEGATIVE BATTERY TERMINAL**
NOTICE:
When disconnecting the cable, some systems need to be initialized after the cable is reconnected (See page 00-00).
10. **INSPECT STEERING PAD** (See page)
11. **CHECK SRS WARNING LIGHT**
(a) Check the SRS warning light (See page 00-00).